



DMX-UB4

4 ZONE DMX WALL CONTROLLER

4 Scenes, 16 Modes



The UB4 RGBW DMX controller is an Intelligent wall mounted Touch Panel.

It has 4 zones with a single universe DMX 512 output.

This controller features a glass touch with an aluminum frame, has multi-scene and multi-zone control. For more control, add the optional Bluetooth5.0.

Bluetooth®  LISTED  RoHS  FCC ID: 2AVCY-UB5

DMX UB4

SPECIFICATIONS



DATA

Input

12-24VDC (Powered by Class 2)

Control

RGBW

Wireless Control

Bluetooth 5.0 SIG Mesh

Output Signal

DMX 512

Zones

4

Operating Temperature

-20°C-55°C

Dimensions

4.72" x 2.95" x 1.16" (120 x 75 x 30mm)

Weight

0.49lbs (225g)

CONNECTION

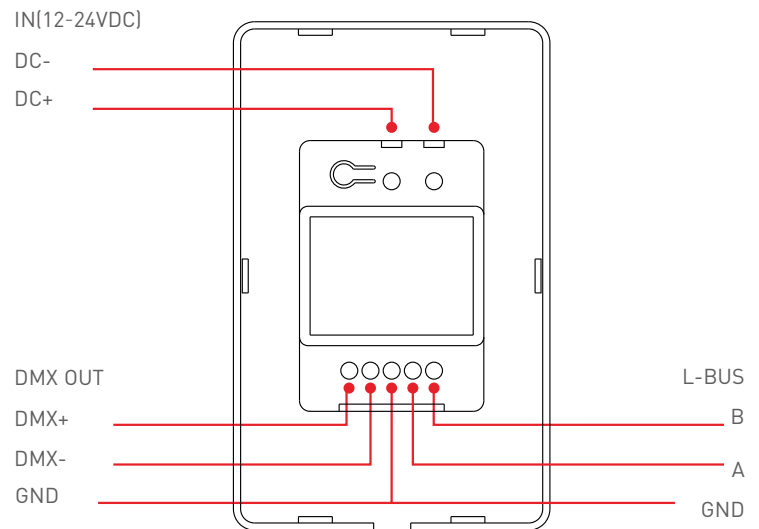

DMX UB4

SPECIFICATIONS



16 modes
 Short press: Play mode
 Long press: Adjust speed

Short press: ON/OFF RGB
 Long press: Adjust
 RGB brightness

Short press: All ON/OFF

16 modes (Press "⊗" to switch)

1. 3 color jumping
2. 7 color jumping
3. White strobe
4. 7 color strobe
5. Red green gradient
6. Red blue gradient
7. Green blue gradient
8. Red yellow gradient
9. Blue purple gradient
10. Green yellow gradient
11. Blue cyan gradient
12. Red purple gradient
13. Blue white gradient
14. Yellow purple cyan gradient
15. 3 color gradient
16. Full color gradient

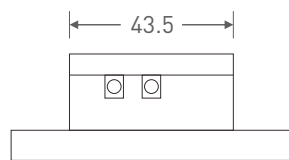
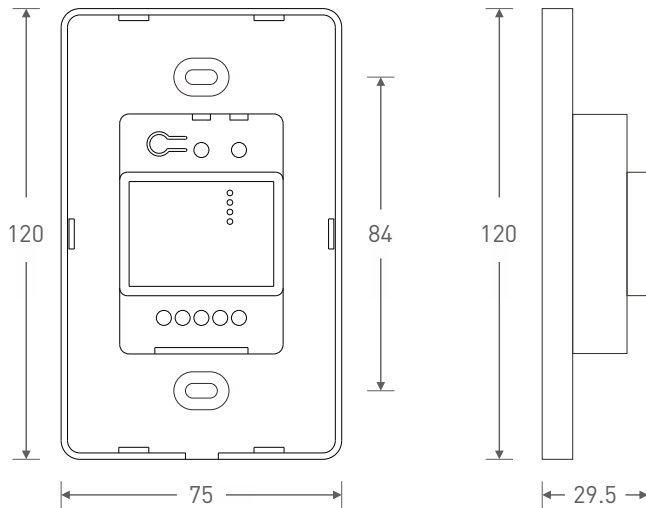
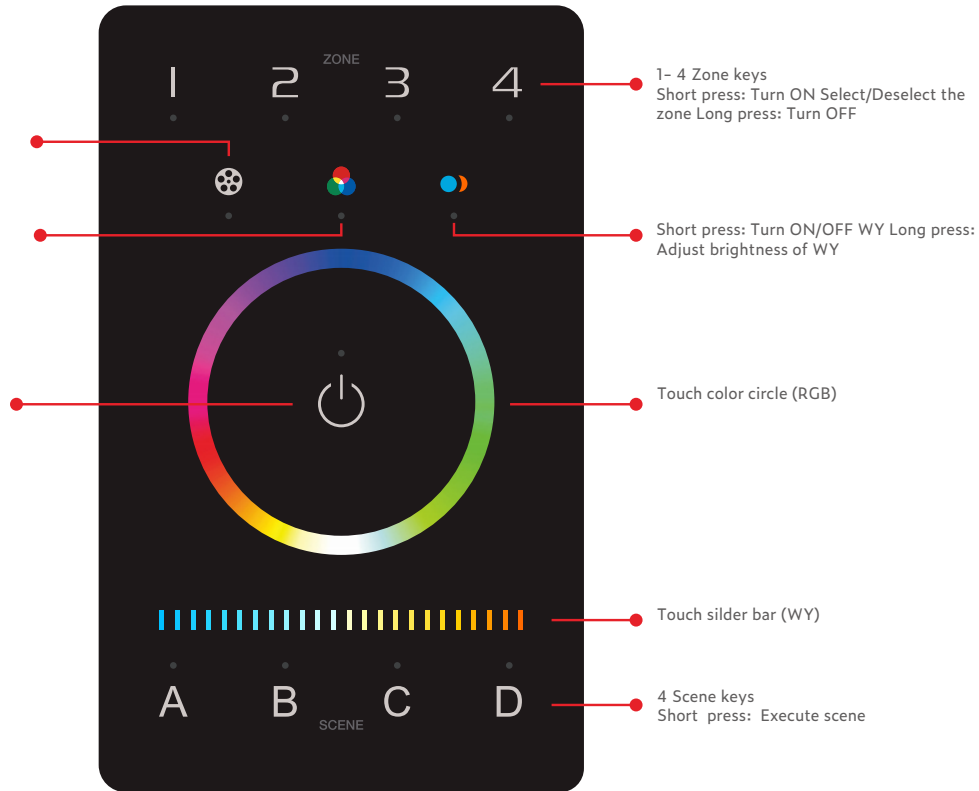

(Top View)

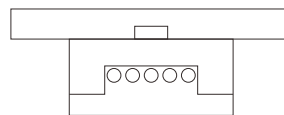

(Bottom View)



App Operating Instructions

1. Register an account

- 1.1 Download L-Home on the app store with your mobile phone and follow the prompts to complete the app installation.
- 1.2 Open the App and log in or register an account.

2. Pairing instructions

Create a home if you are a new user. Click "+" icon in the upper right corner and access the "Add device" list. Follow the prompts to add a LED driver first, then pick "LED controller-Touch panel" from the device list. Follow the prompts to activate the device, then click "Bluetooth search" to add the device.

To reset the device to factory defaults: When the panel is powered on (the indicator light is white), long press Key A and Key D for 6s. If all the indicator lights of the panel flash several times, it means the device has been reset to factory defaults.

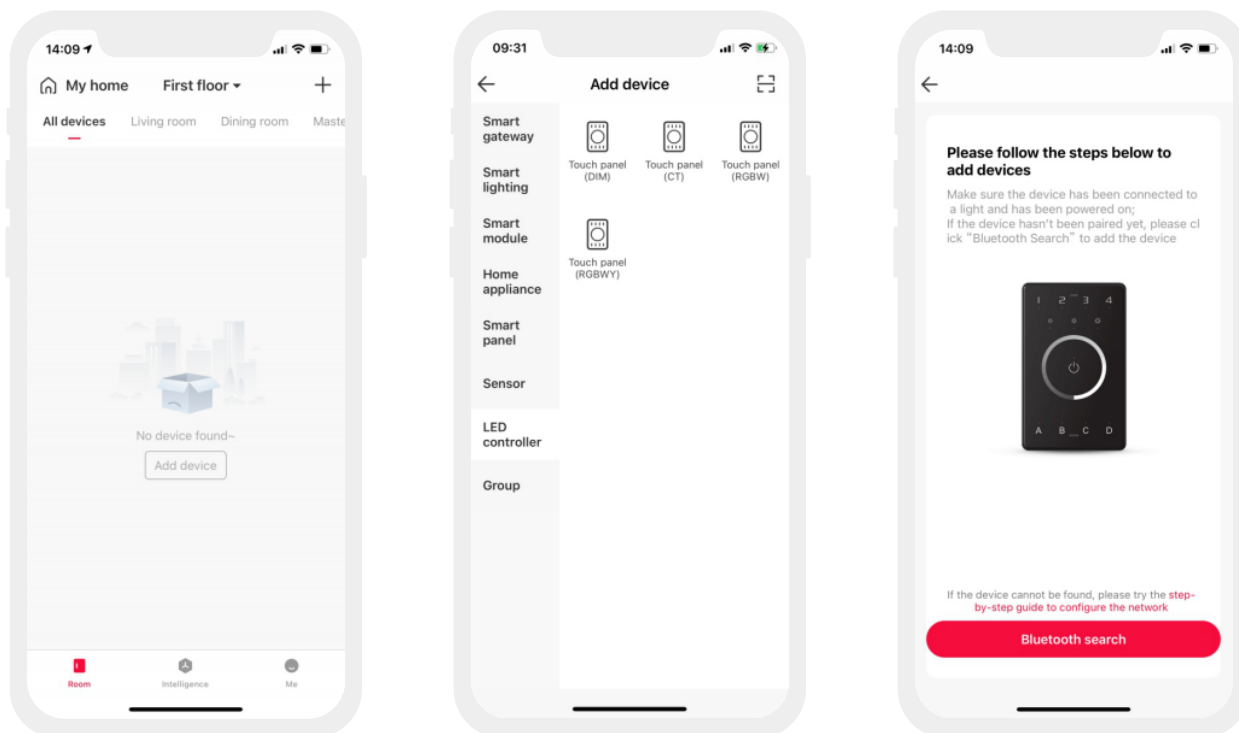

3.How to control lights / light groups and save scenes

After pairing, get access to the control interface and choose the button for the zone lighting you are going to edit. You can bind lights and light groups to the buttons.

Local scenes: After adjusting the zone lighting to appropriate status, click "Save" and follow the prompts to save zone lighting status in the scene. After saving, click the corresponding scene button to execute the current local lighting scene (Supporting 16 scenes).

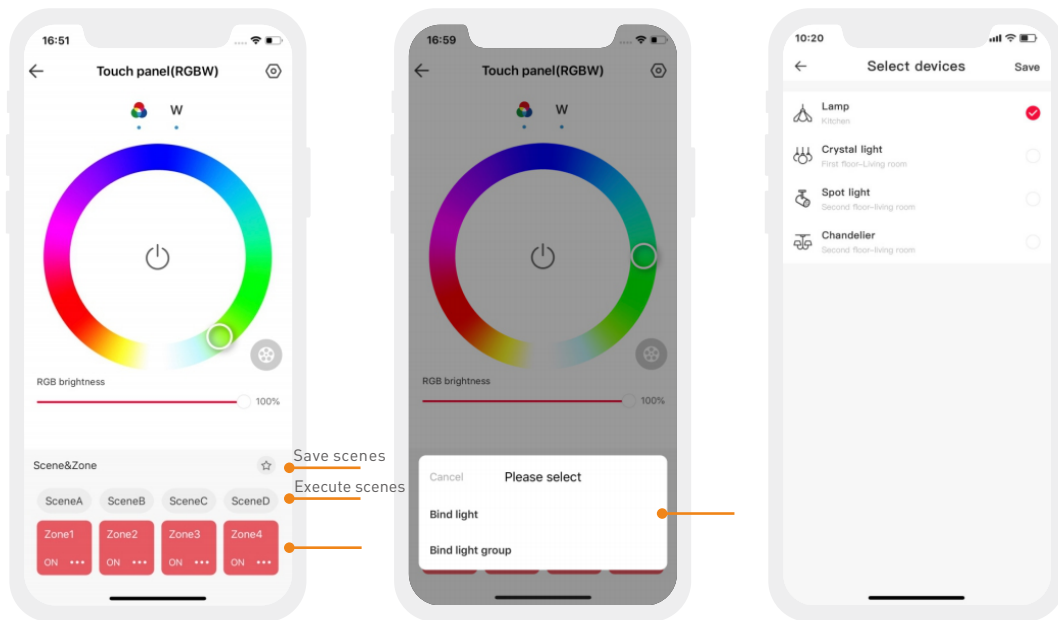

5. Normal modes and advanced modes

Normal modes: Click “Mode” icon and access the mode interface. Click the blank area of the mode and it can be executed. There are 12 editable normal modes in total which satisfy the general needs of customers(Currently, only RGBW & RGBWY support normal modes).

Advanced modes: Click the blank area of the mode and it can be executed. There are 8 editable advanced modes in total which satisfy the general needs of customers.

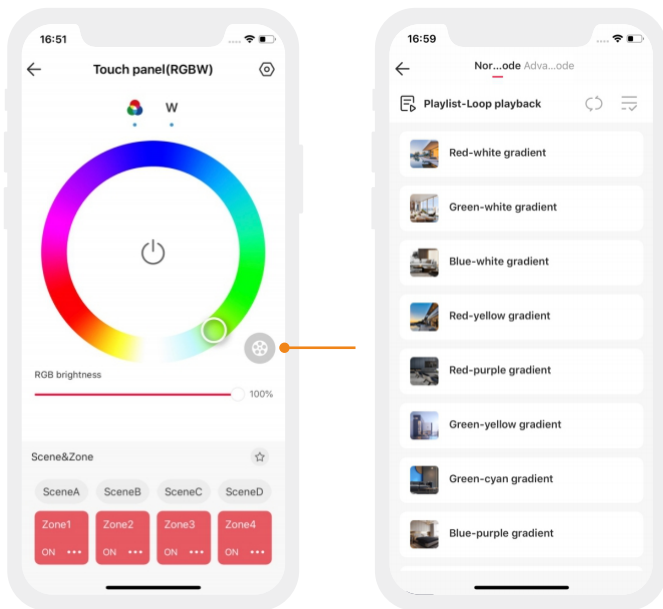

Edit modes: Switch to “Me” menu and click “Lighting mode settings”. After selecting the light fixture type, click the blank area of mode to get access to the editable mode interface and edit it.

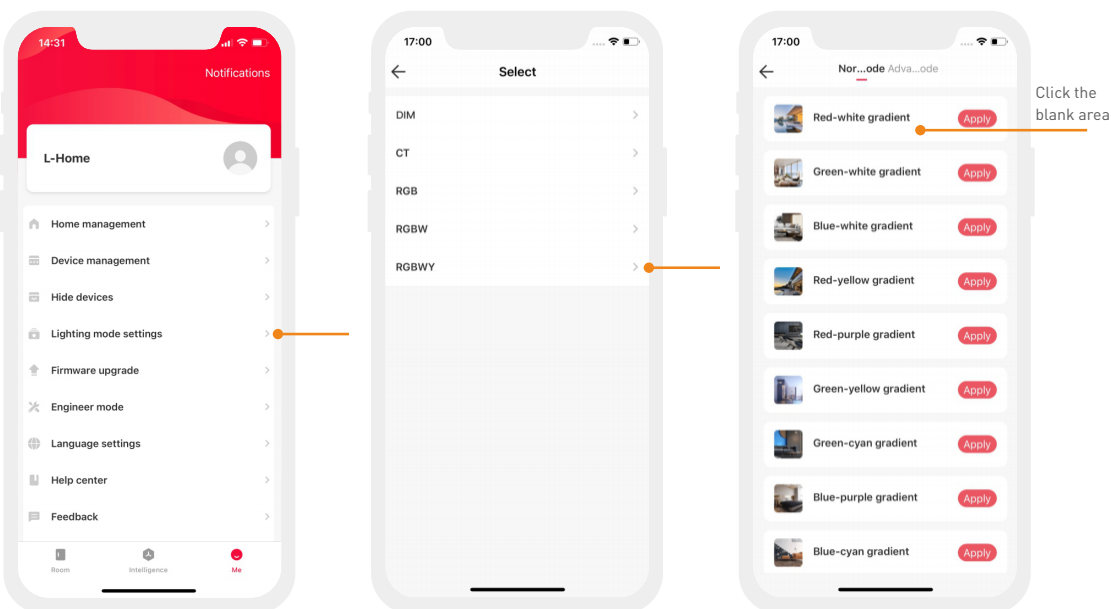

After complete editing, click “Apply” and the mode can be applied to the device.

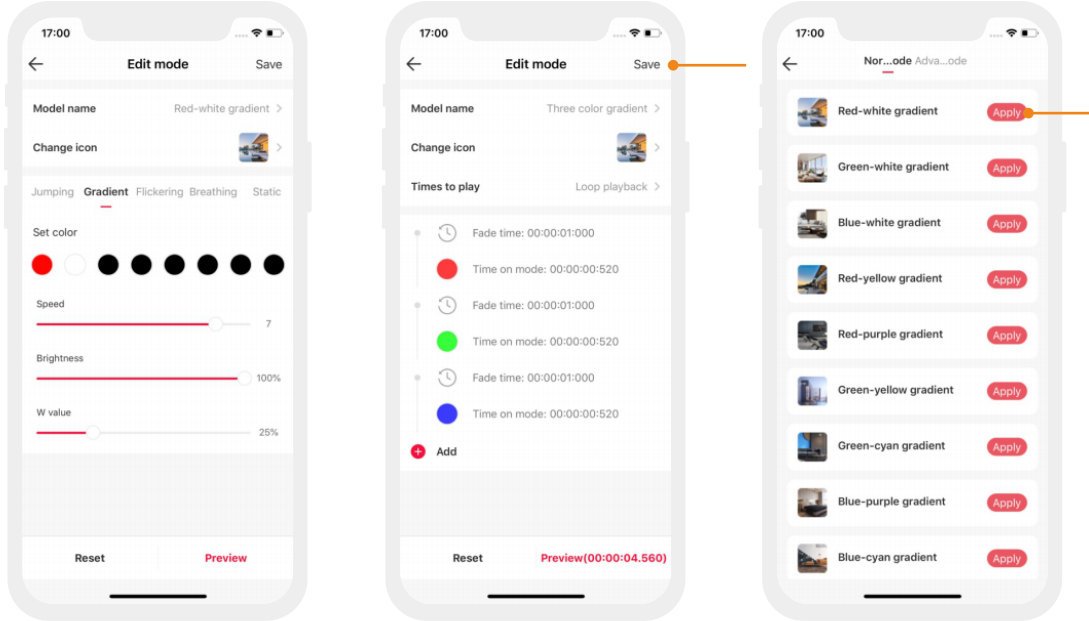

6.How to share control of your home

The home sharing mode adopted is able to share the home or transfer the home founder to other home members. Switch to “Me” menu and choose “Home management”. Click the home that you want to share and click “Add member”, then follow the prompts to complete the home sharing.

